



## MEETINGS & EVENTS



MASLOW'S

# TABLE OF CONTENTS

.....

01 About Us

.....

02 Meeting Rooms & Private Dining

.....

12 The Menu

.....

15 Celebrations

.....

24 Contact Us



# ABOUT US



Maslow's is a multi-faceted hospitality group that creates members' houses, workspaces, restaurants & bars that are developed, branded, activated and operated in vibrant neighbourhoods, inspired by Maslow's theory of human motivation and happiness.

.....

## 1 . W a r w i c k

Located in a Neo-Baroque mansion on a dynamic corner of London's storied Soho, 1 Warwick is set over six floors, and home to beautifully designed workspaces, 5 meeting rooms, 2 lounges, dynamic event spaces, a studio and gym – as well as a rooftop restaurant and bar with sweeping views of the neighbourhood, which has played muse to centuries of creatives.



pn

pn

# LIVE WELL WORK WELL

MASLOW'S





# MEETING ROOMS

---





# GLASSHOUSE





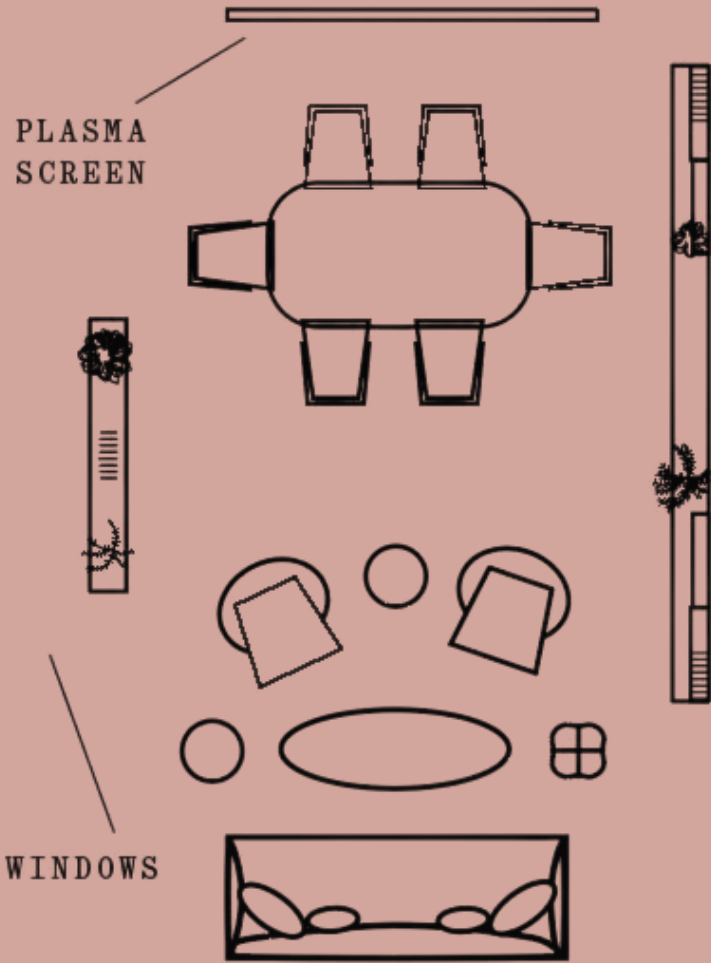

201

This versatile meeting room with a mid-century finish features informal lounge seating and a boardroom table seating six. Overlooking Warwick Street, this room is ideal for small meetings, previews, podcast recordings and intimate dinners alike.



# LEXINGTON &





# MARSHALL



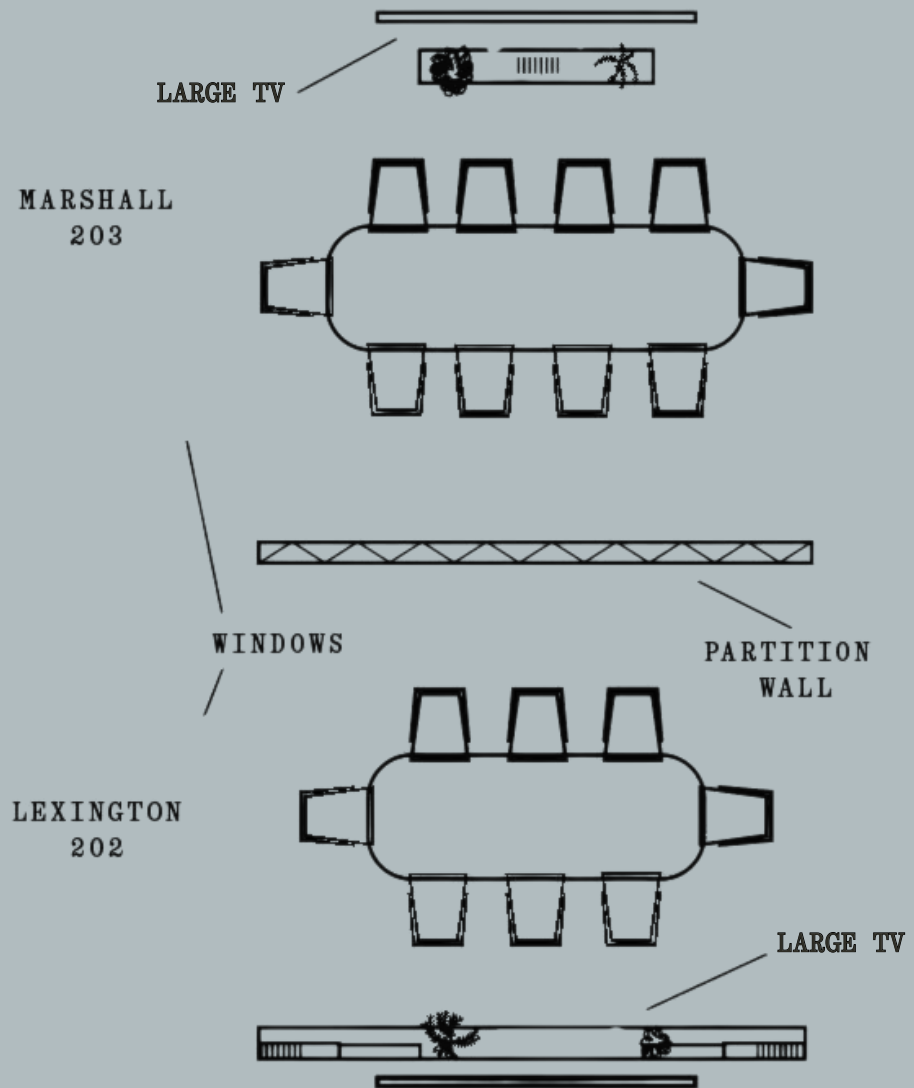

Standing side-by side and linked via a retractable sound-proofed partition wall, these two rooms can be combined to offer seating for 16 guests in a single table layout.

Together or reserved alone, each room is the perfect space to host private conferencing, working lunches or intimate dinners.

202

&

203



# LEXINGTON & MARSHALL



# LEXINGTON & MARSHALL

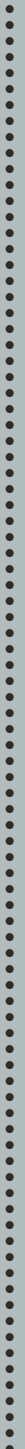
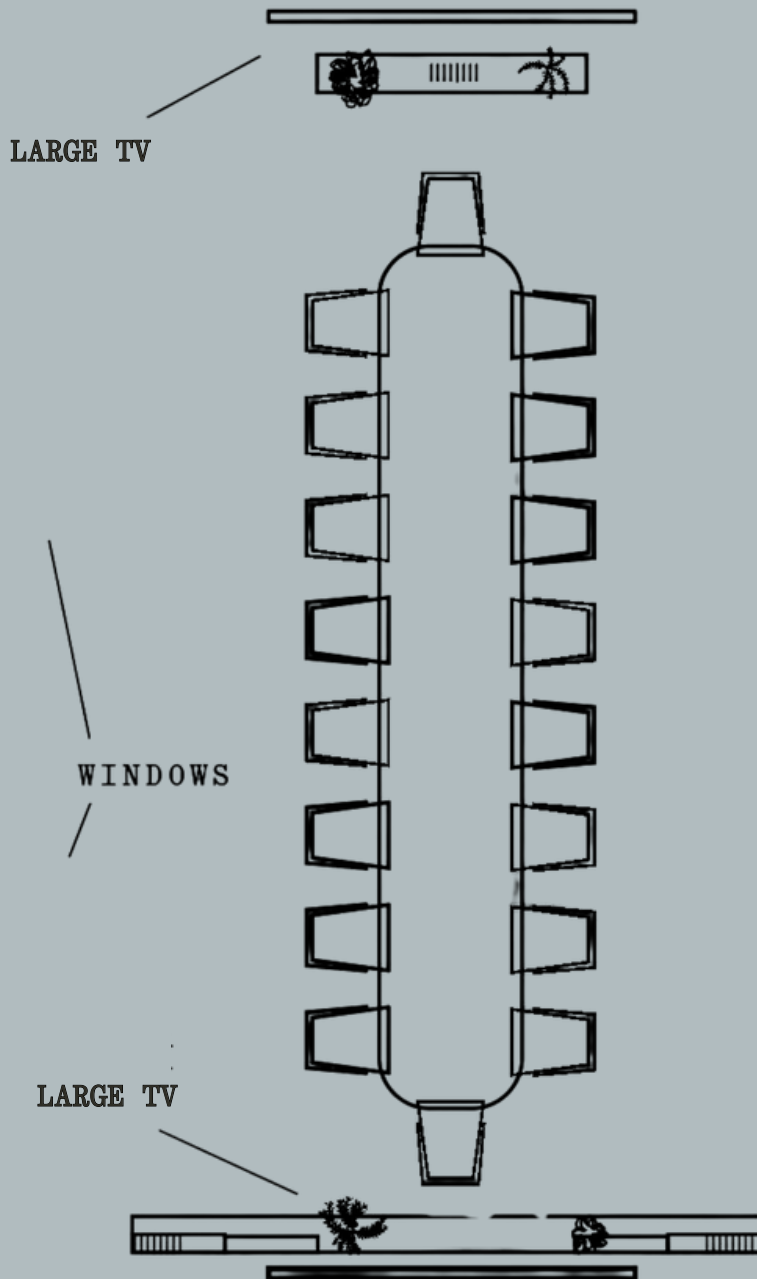



# HOPKINS



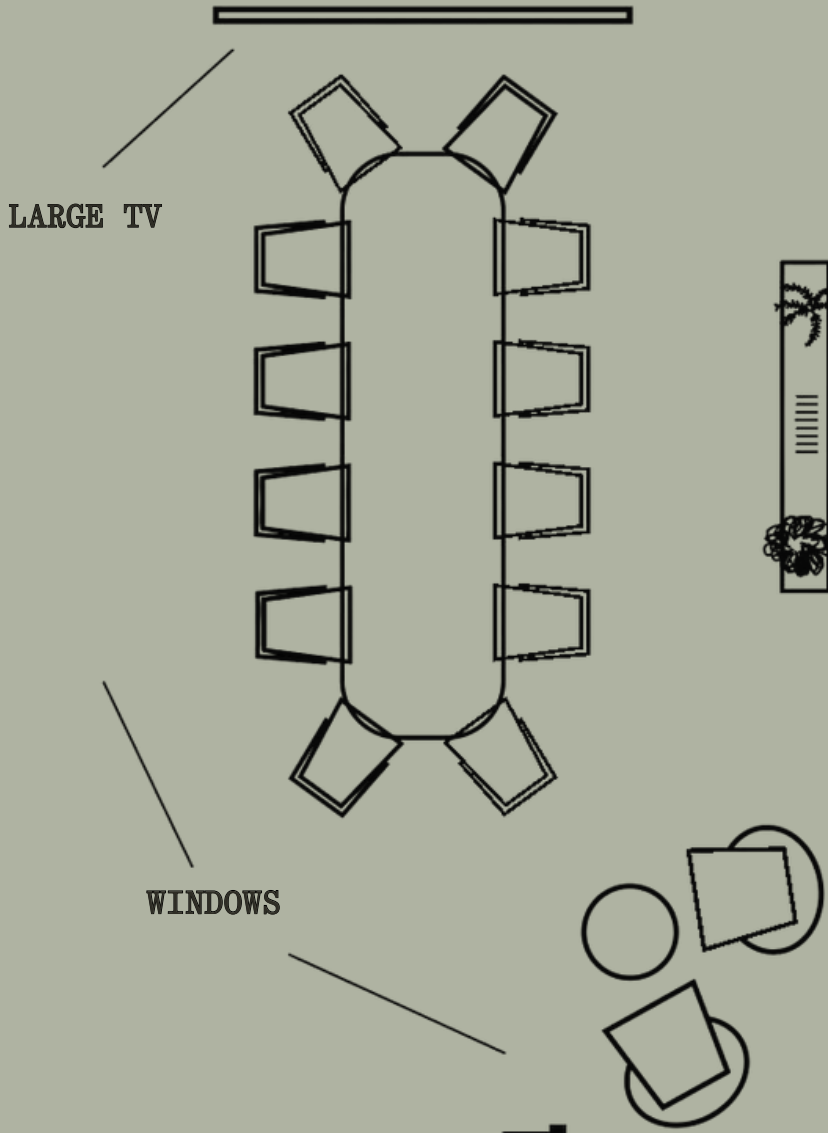

# 204

The largest of the four individual spaces on the second floor, this room features a large custom-made timber boardroom table for up to 12 people seated either boardroom style or for an intimate private dinner setting.



# THE MENU





# THE MENU





# THE DRINKS



# CELEBRATIONS





# THE LIBRARY







With luxurious sofas to sink into and a thoughtful design, the Library is a welcome retreat from the lively streets of Soho. With a fully equipped bar, the space can host up to 80 people.

Other features in the Library include discreetly integrated power sockets, a large A/V screen with sliding artwork to conceal and a set of wall mounted speakers which can be played to through a dual XLR input or Bluetooth.





# SOCIAL SET UP

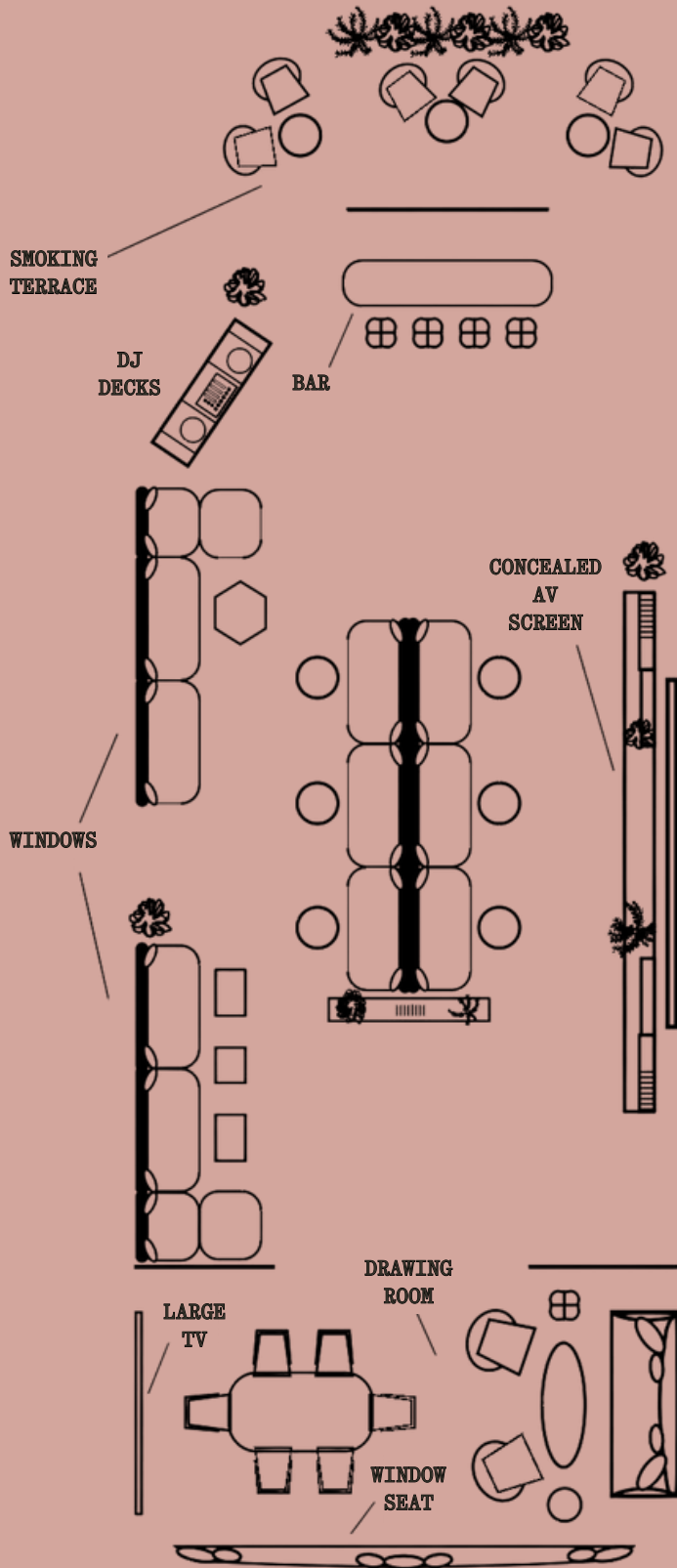

# THE DRAWING ROOM





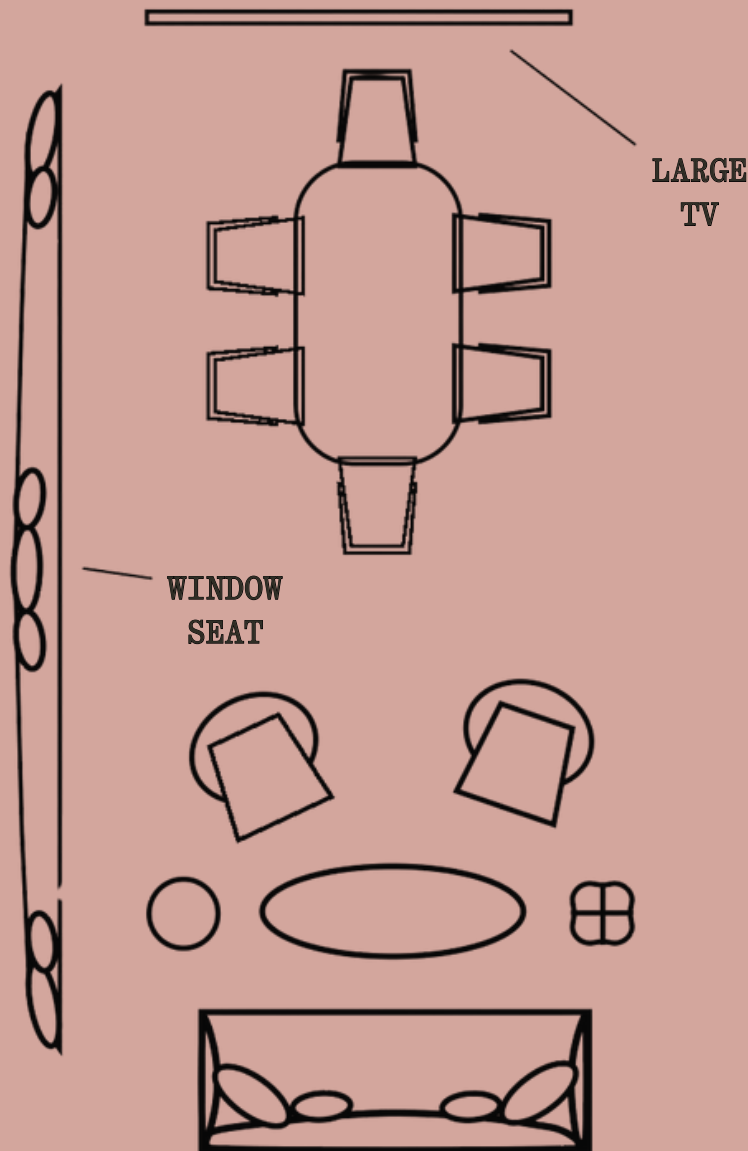

Next to the Library, The Drawing Room, looks out over Warwick Street, through its large bay window - accommodating up to 12 people seated or up to 20 standing, for drinks and canapés.

Retractable curtains and timber bifolding doors separate this space from the Library, allowing members the option of full privacy - making it ideal for private dining, photo shoots and cosy get-togethers.

# YASMIN







Yasmin is our rooftop restaurant, bar and terrace with panoramic views. On the menu, you will find cocktails, wines and a variety of Middle Eastern dishes inspired by executive chef Tom Cenci's time in Istanbul.

The West Terrace, overlooking Warwick Street, is a semi-private space, with a retractable canopy and outside heaters. This space is perfect for a relaxed lunch or dinner for up to 20 guests or a drinks reception for up to 40 guests. The full restaurant can be hired for large celebrations.

# OUR ROOMS AT A GLANCE

BY THE HOUR	Capacity
Glasshouse 201	10
Lexington 202	08
Marshall 203	10
Hopkins 204	12

---

MINIMUM 4 HOURS	Capacity
The Library	80
The Drawing Room	08
Lexington 202 &	16
Marshall 203	18

---

YASMIN, The West	Capacity
Terrace & Private Hire	
TWT, Seated	20
TWT, Standing	40
Whole Restaurant	100



# FIND US

---



# CONTACT US



MASLOW'S

1 Warwick St, London W1B 5LR

[www.1warwick.com](http://www.1warwick.com)

[events@1warwick.com](mailto:events@1warwick.com)

[@1warwicksoho](https://www.instagram.com/1warwicksoho)